

DATA SHEET

FULL SADDLES Hot Dip Galvanised

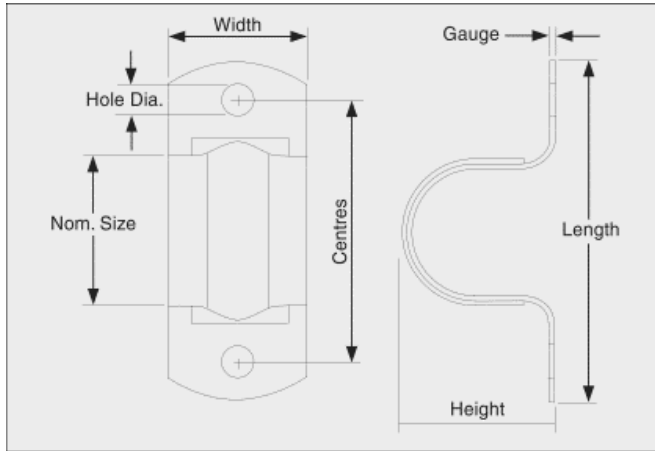

CODE	Size (mm)	Gauge (mm)	Hole Dia. (mm)	Hole Centre (mm)	Length (mm)	Width (mm)	Height (mm)	Box/Ctn. Qty (pcs)
LC-FS16HDG	16mm	1.0	6.5	32	45	13	24	150/1200
LC-FS20HDG	20mm	1.0	6.5	39	50	16	23	100/800
LC-FS25HDG	25mm	1.0	6.5	48	62	19	28	100/800
LC-FS32HDG	32mm	1.2	6.5	63	79	25	35	50/400
LC-FS40HDG	40mm	1.2	6.5	71	87	25	44	50/400
LC-FS50HDG	50mm	1.2	6.5	92	108	25	53	25/200
LC-FS63HDG	63mm	1.6	7.2	107	130	39	66	20/120
LC-FS80HDG	80mm	1.6	9.2	136	166	40	92	15/120
LC-FS100HDG	100mm	1.6	9.2	160	190	40	118	10/80

Features:

- ↗ As per AS/NZS 4680:2006
- ↗ Hot Dip Galvanised quality/finish
- ↗ Used for securing Electrical PVC Rigid/ Flexible or Corrugated Conduit in place
- ↗ Optimal corrosion protection
- ↗ Accommodates 6.5mm Nail in Anchors