

Full Saddles (316 Grade Stainless Steel)

- For the securing of electrical conduits (rigid and flexible) to solid surfaces in industrial and commercial environments

Product Details:

- Material - 316 Grade Stainless Steel
- Standards - Manufactured to comply with AS/NZS 4680:2006
- Fixings - Accommodates 6.5mm nail in anchors
- Applications - For the securing of electrical conduits to solid surfaces
- Suitable for installation in marine and submerged environments

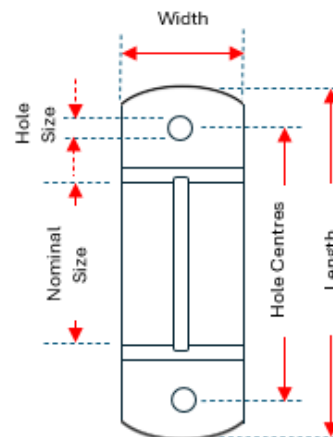

Product Catalogue No.	Nominal Size (mm)	Thickness (mm)	Hole Size (mm)	Hole Centre	Length (mm)	Width (mm)	Height (mm)
LC-FS16SS	16mm	1	6.5	32.0	45.0	13.0	24.0
LC-FS20SS	20mm	1	6.5	39.0	50.0	16.0	23.0
LC-FS25SS	25mm	1	6.5	48.0	62.0	19.0	28.0
LC-FS32SS	32mm	1	6.5	63.0	79.0	25.0	35.0
LC-FS40SS	40mm	1	6.5	71.0	87.0	25.0	44.0
LC-FS50SS	50mm	1	6.5	92.0	108.0	25.0	53.0