

DATA SHEET

FULL SADDLES SS316

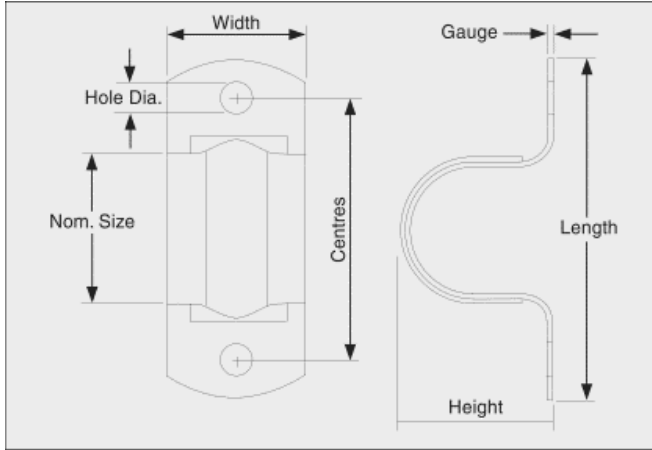

CODE	Size (mm)	Gauge (mm)	Hole Dia. (mm)	Hole Centre (mm)	Length (mm)	Width (mm)	Height (mm)	Box/Ctn. Qty (pcs)
LC-FS16SS	16mm	1.0	6.5	32	45	13	24	150/1200
LC-FS20SS	20mm	1.0	6.5	39	50	16	23	100/800
LC-FS25SS	25mm	1.0	6.5	48	62	19	28	100/800
LC-FS32SS	32mm	1.2	6.5	63	79	25	35	50/400
LC-FS40SS	40mm	1.2	6.5	71	87	25	44	50/400
LC-FS50SS	50mm	1.2	6.5	92	108	25	53	25/200

Features:

- Made from Genuine 316 Grade Stainless Steel strip
- Used for securing Electrical PVC Rigid/ Flexible or Corrugated Conduit in place
- Suits marine and submerged applications
- Accommodates 6.5mm Nail in Anchors